

*An era of
grandeur and elegance
is reborn.*

Built in 1893, during New Orleans' "Golden Age," The Roosevelt has hosted Kings, Queens and Presidents through the ages.

Join us as we usher in a new era of luxury in New Orleans.

R



The Roosevelt, originally one of the South's first grand hotels, has returned to its place as the premier luxury hotel in New Orleans. With a \$145 million restoration, The Roosevelt combines its legendary past with personal service and modern comforts for an extraordinary present.

Boasting nearly 60,000 square feet of event space, including three spectacular ballrooms and 23 individual meeting rooms, The Roosevelt offers the level of service you would expect from a Waldorf Astoria Collection™ hotel. Each of the 504 luxury guest rooms, including 135 elegant suites, is dressed in exquisite décor and features contemporary amenities for a luxurious, unforgettable stay.

An opportunity to indulge lies around every corner at The Roosevelt. Savor the legendary Blue Room, unwind at the historic Sazerac Bar, enjoy world-class cuisine at Domenica, our John Besh signature restaurant. Or you can open the magnificent brass doors and let your senses take you just steps away to all the history, culture, entertainment and food that the French Quarter has to offer.

ROOM	THEATRE	SCHOOLROOM	BANQUET	RECEPTION	CONFERENCE	H/S	DIMENSION	CEILING	SQ. FOOTAGE
MEZZANINE LEVEL									
ROOSEVELT BALLROOM	1,500	940	1,295	2,500	N/A	280	172x117	20'	20,124
ROOSEVELT FOYER / SALON I	220	135	190	360	N/A	40	68x38	20'	2,584
SALON II, III OR IV	175	110	150	290	N/A	30	68x30	20'	2,040
SALON V	218	137	190	365	N/A	40	68x40	20'	2,720
ROOSEVELT PROMENADE	N/A	N/A	N/A	N/A	N/A	N/A	34x162	20'	5,500
CRESCENT CITY BALLROOM	1,227	527	704	1,800	N/A	180	113x108	18'9"	12,204
WALDORF ASTORIA BALLROOM	700	350	650	800	N/A	80	88x77	13'8"	6,776
PONTALBA ROOM	60	40	70	100	30	30	41x17	13'8"	697
CONTI ROOM	100	60	100	125	40	40	40x36	13'8"	1,440
LAFITTE ROOM	60	30	40	60	30	25	35x17	13'8"	595
NAPOLEON ROOM	60	30	40	60	30	25	34x17	13'8"	578
BIENVILLE ROOM	80	40	70	80	30	30	31x29	11'	899
SECOND LEVEL									
ORPHEUM ROOM	300	160	240	350	40	40	37x65	11'3"	2,405
PRYTANIA ROOM	25	15	20	25	20	N/A	24x12	9'2"	288
SAENGER ROOM	20	12	20	20	14	N/A	21x12	8'	252
HUEY P. LONG EXECUTIVE BOARDROOM	N/A	N/A	N/A	N/A	18	N/A	38x15	10'	570
PRODUCERS ROOM	30	25	30	30	20	N/A	27x15	8'4"	405
DIRECTORS ROOM	30	25	30	30	20	N/A	27x15	8'4"	405
MAYOR'S SUITE LEVEL (CHAMBERS I-IV)									
CHAMBER I	100	50	60	100	30	30	36x31	9'	1,082
CHAMBER II	100	50	60	100	30	30	36x28	9'	982
CHAMBER III	100	60	90	120	30	30	43x29	9'	1,247
CHAMBER IV	100	60	90	120	30	30	43x28	9'	1,193
CHAMBERS I & III COMBINED	300	120	180	200	50	50	79x31	9'	2,449
CHAMBERS II & IV COMBINED	300	120	180	200	50	50	79x28	9'	2,212
BLUE ROOM - LOBBY LEVEL	200	90	250	400	40	40	94x58	15'4"	5,452



*A new age of luxury is alive in New Orleans.
Experience the grandeur of The Roosevelt Hotel.*

MEZZANINE LEVEL



LOBBY LEVEL
BLUE ROOM

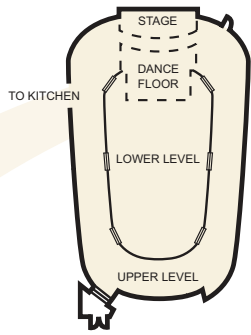

SECOND LEVEL



MAYOR'S SUITE LEVEL

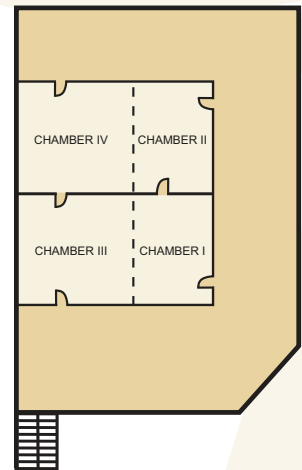

Legendary Amenities

Blue Room Brunch and Entertainment
Sazerac Bar and Restaurant
Domenica, a John Besh Restaurant
Coffee and Sweets Boutique
Guerlain Spa
12,000-square-foot health and wellness center
Outdoor pool and French Quarter-style courtyard
Comprehensive Business Center
Private Dining and Suite Butler Service
The Roosevelt Gift Shop

Cultural Attractions

The Historic New Orleans Collection
Longue Vue House and Gardens
Aquarium of the Americas
Audubon Insectarium
Contemporary Arts Center
The Ogden Museum of Southern Art
New Orleans Museum of Art
Louisiana Children's Museum
The National WWII Museum
New Orleans Ballet Theatre
Louisiana Philharmonic Orchestra

Rooms

Total Rooms 504
Luxury Accommodations 369
Elegant Suites 135

Landmark Attractions

Royal Street Art and Antiques
St. Louis Cathedral
Bourbon Street
Jackson Square
French Market
Immaculate Conception Jesuit Church
St. Charles Avenue Streetcar
Historic Garden District
Mississippi River attractions

Other Attractions

Harrah's Casino
Mardi Gras World
Carriage Tours of the French Quarter
Swamp Tours
Magazine Street Art and Antiques



For more information contact Mark Wilson, Director of Sales & Marketing

504.648.5380 • mark.wilson@hilton.com

TheRooseveltNewOrleans.com

123 BARONNE STREET • NEW ORLEANS, LA 70112